

Pine Hill Road

C OF ROAD

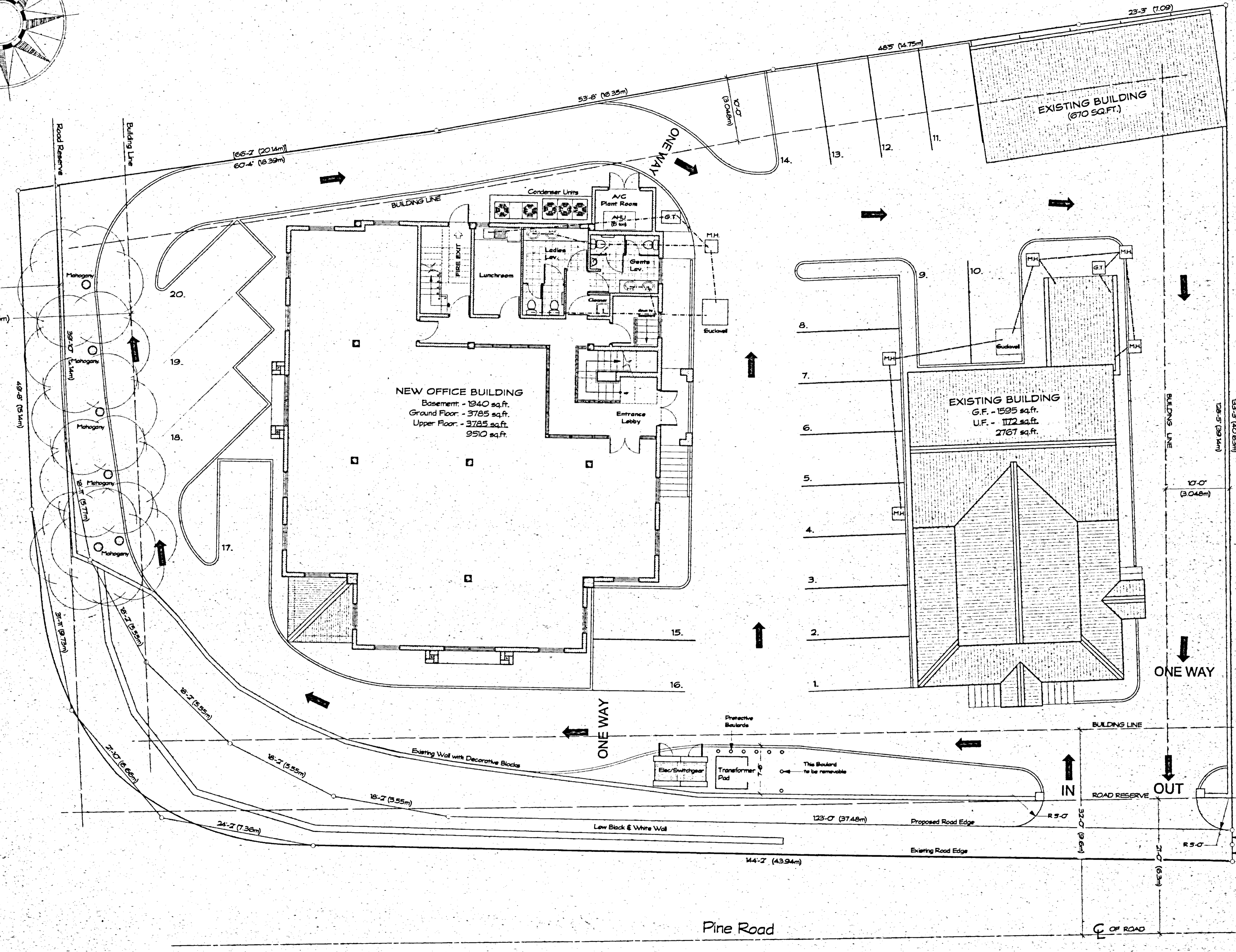

No.	Description	Date
C	A/C Plantroom & Elec. Switchgear added Roof to Basement entrance shown	24 Nov. 2000
B	Transformer Pad location amended	25 Aug. 2000
A	General amendments	July 2000

GILLESPIE & STEEL
 GILLESPIE AND STEEL ASSOCIATES LTD
 CHARTERED ARCHITECTS
 PRIOR PARK HOUSE ST JAMES BARBADOS
 TEL: (246) 425-1356 FAX: (246) 424-0334
 email: g&s@sunbeach.net

MAEK INC.
 New Office Building

Drawing Title
Site Plan

Drawn by A. Giese	Check by 18th Jan 2000
Scale 1/8" = 1'-0"	Rev C
Project No. M140	Sheet No. A1